

## DL106

### High Brightness Diffuse Dome



- Aii** 2x brighter than DL7248 in white
- Aii** Provides diffuse illumination for inspection of specular objects.
- Aii** Rugged construction

#### Ordering Information

Standard Product:  
Shipped Next Day

#### DL106-WHIIC

Configured with inline  
Current Source

#### DL106-625IC

Configured with inline  
Current Source

Standard Product Variation:  
Shipped Within Two Weeks

		Spectral wavelength		Alternative Connector
DL106	-	XXX	XX	XXX
		(UV) 395	IC	M12*
		(blue) 470	IS	
		(green) 530	C2	
		(amber) 590	C3	
		(red) 625	C5	
		(IR) 850		
		(white) WHI		

IC = ICS (requires 24v power supply)  
IS = ISU (requires 24v power supply)  
C2 = Ai Connector  
C3 = Pulsar 710 Connector  
C5 = Pulsar 320 Connector  
\* Available with IC and 24v options only

**Optimal working distance:**  
12.7mm (0.5")  
**Effective Working Range:**  
12.7 - 50mm (0.5 - 2.0")

#### Intensity Distribution

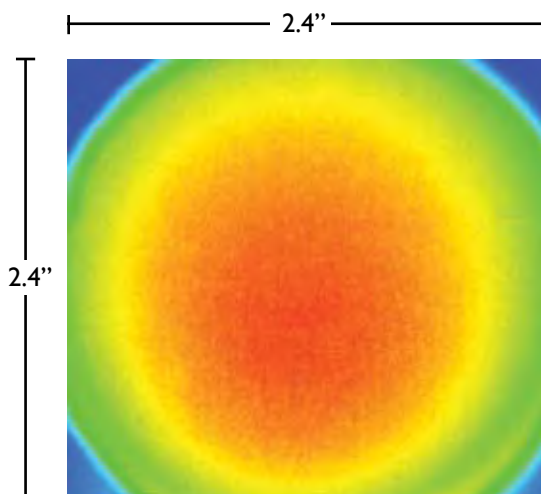

Dimensional Information

[Click for Installation Models & Drawings](#)

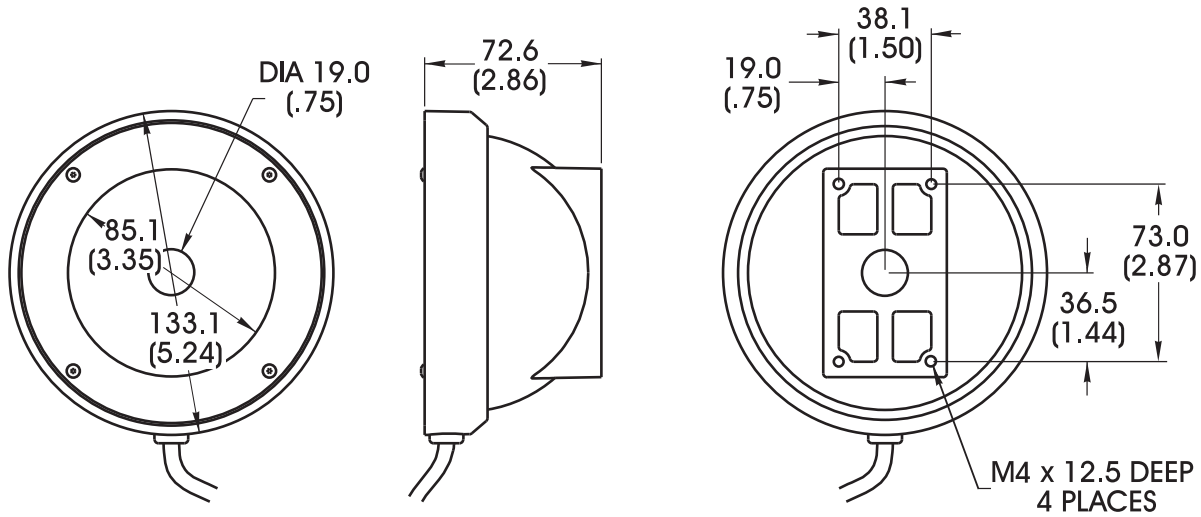

Cable Length: 1.5 Meter (59")

DIMENSIONS ARE IN MILLIMETERS (INCHES)

Standard Variation Current Specifications

	UV	blue	green	amber	red	infra-red	white	
Ai / iCS	350	350	350	350	350	350	350	mA

Standard Product Information

White	Max. Illumination	Irradiance (mW/cm <sup>2</sup> )	Illuminance (Lux)
Working Distance: .5"		5.45	24,500
Working Distance: 1.0"		4.25	18,500
Lifetime	50,000 hrs		

General Specifications

Weight:	662.2 g (23.4 oz)
Finish:	Black Anodized
Operating Temperature:	0-60° C
Meets Specifications:	CE, RoHS

Additional Information

CB010 Mounting Bracket (Included) Dimensions:

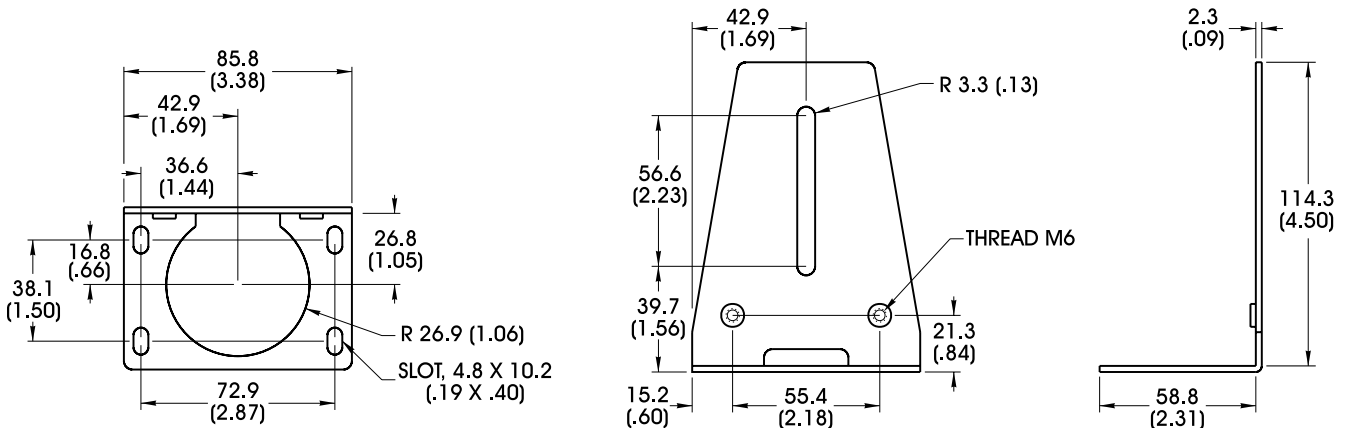

802.767.3830